

Owner's Manual for Professional Remote Dog Trainer AT-918C



**Aetertek**<sup>®</sup>  
Training Systems



550 Meters



AT-918C

[www.aetertek.com](http://www.aetertek.com)

[www.facebook.com/groups/AetertekFans](https://www.facebook.com/groups/AetertekFans)

All Rights Reserved

**owner's manual**

[www.aetertek.com](http://www.aetertek.com)

# Index

System Included-----	1
Quick Start-----	2,3
Trouble Shooting-----	4,5
Training Tips-----	6
Safety Guidance-----	7
Information for Terms of Use & Limitation of Liability-----	8
Warranty Card-----	9,10

# AT-918C System Included



- Transmitter
- Antenna
- Receiver
- prongs
- Test Kit
- Collar
- Charger



Transmitter



Antenna

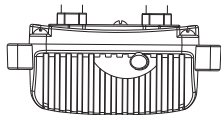

Receiver



prongs

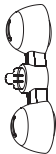

Test Kit



Collar



Charger

# Quick Start

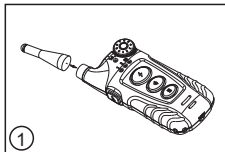

**Step 1:** Screw the antenna tightly onto the transmitter.



**Step 2:** Charge the transmitter. The signal light will flicker until battery is fully charged.

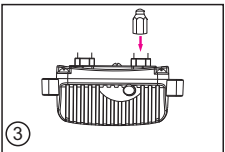

**Step 3:** Screw the metal prongs onto the receiver till securely attached. (Normally it was assembled already in the factory.)

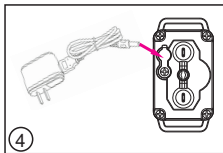

**Step 4:** Charge the receiver. A **Red LED** light of the receiver is on while charging. When charging is over, the **Blue LED** will light up. Once you unplug the charger, the **Red LED** light will stay in solid-waiting for sync, at the same time, the **Blue LED** light will go off.

*Tip 1: Recommend to charge the transmitter and receiver up to 3 hours for the first 3 times*

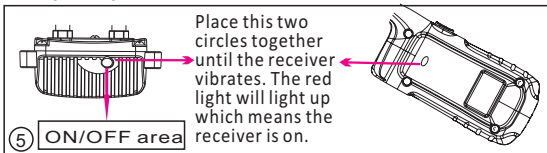

Place this two circles together until the receiver vibrates. The red light will light up which means the receiver is on.

**Step 5:** Turn the receiver on. Place the two circles together until the receiver vibrates. The red light will light up which means the receiver is on. If you just finished charging, unplug the charger, the receiver is on already.

*Tip 2: To do a self-test, place the remote circle near receiver ON/OFF area (the circle part) 3 times, it should beep, vibrate and shock with blue light up, indicating a functional unit.*

# Quick Start

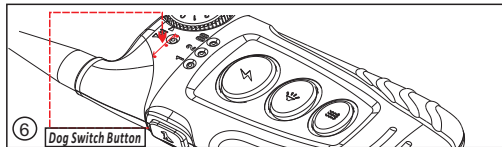

**Step 6:** Match the receiver and transmitter. Choose the dog mode (Dog1, dog2 or dog00) by pushing the dog switch button on the left of the transmitter. For the first receiver, choose dog 1 and quick press one of the three buttons on the front, the first receiver will be connected with the remote along with red light turns off and blue light starts flash. If you have another receiver, turn it on and choose dog 2, press any function buttons. The second receiver will be paired; You can train different dogs separately in different dog system. If Dog00 is selected, both dogs will receive correctional signals.

**Tip 3:** After 3 minutes of inactivity, transmitter will go into sleep mode. You can wake it up by pressing any function keys (Vibrate, Shock and Beep).

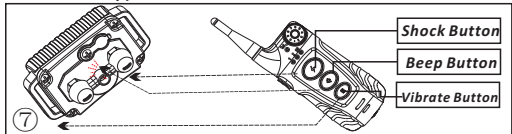

**Step 7:** Check the button functions. Push the beep button, the receiver will produce beeping sound and similarly, push the vibrate button, it will cause vibration. Cap the shock test kit on the metal prongs, and push the shock button. If the bulb lights up, the shock function is ok.

**Tip 4:** Longer(shorter) holding beep, vibrate or shock button will lead to longer (shorter) duration of beep, vibrate or shock time.

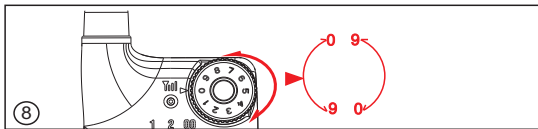

**Step 8:** Adjust the intensity of shock function by rotating the thumbwheel dial. 1-9 levels can be chosen.

**Step 9:** Start to train. Put the collar into the receiver and wear the receiver around dog's neck. Remember to leave one finger place between collar and neck, then it's ready to train.

**Tip 5:** For 918C, auto Anti Bark function is available. Press Dog Switch button for 3 seconds, then the signal light will be solid blue. Do it again, the Auto Anti Bark function will be turned off. In dog00 system, auto anti bark function is automatically off which cannot be turned on. Please turn auto anti bark function off timely when not in use.

# Trouble Shooting

## **A : Transmitter /Receiver runs out of batteries quickly.**

- 1 : Make sure the charger and Transmitter/Receiver are securely connected.
- 2 : Charge it up to 3 hours or above.

## **B : Transmitter doesn't work.**

- 1: Replace the 9v dry battery with a new one or recharge the Transmitter.
- 2: For 919C and 216C, you can check whether you lock the transmitter or no. If so, you can unlock it by pushing both buttons on the right side.

## **C : Transmitter can't match Receiver successfully.**

- 1 : Make sure the intensity level is not on ZERO.
- 2 : Check whether the antenna is installed correctly or not.
- 3 : Ensure the receiver is turned on and in sync waiting status.

## **D : Receiver doesn't response to Transmitter.**

- 1 : Make sure the intensity level is not on ZERO.
- 2 : Make sure Receiver had been synced with Transmitter and Transmitter is in the right dog system. Never change dog system after the system had been synced!
- 3 : Make sure the Receiver and Transmitter have enough power.

## **E : The training system has no effect on my dog.**

- 1 : Make sure the Receiver is working and the shocking prongs touch dog's skin closely.
- 2 : Try increasing the intensity level.

## **F : Transmitter can't remotely control 1-2 or 1-3 Receivers.**

- 1 : Make sure you sync different Receiver separately.
- 2 : Only in the right dog system, can you operate the corresponding Receiver or dog.
- 3 : Whenever the Receiver/Transmitter out of power and recharged, you need to sync them once again.

## **G : The training system is only available in short range.**

- 1 : Check whether the antenna is installed correctly.
- 2 : Make sure there don't have strong signal interference from your surroundings.
- 3 : Remote control range could be fluctuated along with surroundings, obstacles, or even the weather.
- 4 : As to AT-919, make sure the collar had been put through the antenna pole in the back side of Receiver.



# Trouble Shooting



## **H: What's the rubber cap outside of charging port for?**

It prevent dust or water from coming into the charging port effectively. You need to plug the cap into the charging port tightly when charging is done.

## **I : How to turn on/off anti bark feature?**

For 218, press and hold on the flash light button, then quick press down Beep button will turn on/off anti bark feature;

For 219, press and hold on the microphone button for three seconds will turn on/off anti bark feature;

For 918C, press and hold on dog selection button on the side of Transmitter will turn on/off anti bark feature;

For 919C, quick press the flash light button on the back side of Transmitter will turn on/off anti bark feature;

## **J : Receiver beep/vibrate/shock by itself all the time or occasionally .**

1 : Make sure anti bark feature is turned off. For 219, the default setting is on while 218/918C/919C is off. After auto mode feature had been turned off, for 218 and 918C, auto mode LED light will go off; for 219, auto mode icon (MICROPHONE will disappear); for 919C, auto mode icon (SPEAKER) will be hollowed;

2 : Make sure Receiver has enough power, because Receiver will alarm when it runs out of power.

3 : Make sure any buttons of Transmitter has not been touched.

4 : Sync Receiver with Transmitter once again.

## **K : When buying individual Receiver or Transmitter, why do I need to double-check the edition?**

Aetertek updated all machines frequency from 433.92 MHz to 915 MHz, so every time you need to buy individual Receiver or Transmitter, you must make sure which frequency you actually need. Otherwise they will not be compatible.

## **L : After unplugging charger, the red LED light in Receiver stayed in solid to wait for sync, however it can never be synced by Transmitter.**

Please turn off your Receiver and re-sync it.

## **M : My Receiver seems to work by itself without the operation of Transmitter.**

Check whether the auto anti bark function is on. If so, you can turn it off.

## **N : Auto anti bark is not work properly.**

1: Make sure auto anti bark feature had been turned on, then you can test the function by scratching the shocking prongs on the surface of a desk, qualified Receiver will start to beep and vibrate.

2: Do a auto anti bark feature test on [www.aetertek.com](http://www.aetertek.com). (<http://www.aetertek.com/pages/Auto-anti-bark-feature-test.html>).

# Training Tips

---

This product is intended to support behavioral training and is not designed to be used without necessary interaction. Always praise your dog for good behavior. Verbal commands with positive reinforcement will contribute to the success of your training and will achieve the fastest, most desirable results possible.



The recommended age for training is a minimum of 6 months, provided that dog has the attention span and capability to learn basic commands. And it should not be used on aggressive or elderly animals in poor health or animals otherwise unable to withstand the stimulus.

Use verbal commands first, and supplement with a corrective stimulus only as needed. Be consistent with your verbal commands, using the same words every time. Work with your pet on one behavior at a time to avoid confusion and frustration. Use as little stimulus as possible and only to reinforce verbal commands when necessary. Do not over correct your dog.

For example, use the beeps as warning by pressing Beep button. The dog will become conditioned to the beep preceding the corrective stimulus and will soon learn to recognize the beep as a warning along with your verbal command. Do not rely on this product solely to train your dog. Some dogs will not respond to this product. Aetertek cannot guarantee the effectiveness of this or any trainer on your dog. If your dog shows signs of growling, snarling, biting or aggression while using the collar, discontinue use immediately and contact a professional trainer for advice.



# Safety Guidance



1. It is forbidden to open the receiver in case of breakage of the machine or harm the waterproof feature. Otherwise it will violate warranty rules.
2. In order to guarantee submersible feature, the waterproof rubber charging lid should be plugged in tightly.
3. Only use the supplied adaptor to charge the receiver, otherwise the receiver will probably be damaged.
4. Users are NOT suggested to touch the metal prongs on the receiver, otherwise it will harm human body in case of shocking operation. To test shock correction, please use the supplied test kit.
5. If there is water in the charging hole, please dry it before charge the receiver
6. Any collar worn for extended periods can cause a condition similar to bedsores, know as Pressure Necrosis. To reduce the possibility, you must do the followings(**VERY IMPORTANT**):
  - a. Never leave the collar on dog for more than 12 hours per day;
  - b. Examine the dog's neck daily for any signs of a rash or sore;
  - c. Supervise your dog during the first 2 days of training;
  - d. Check the fit to prevent excessive pressure. you should be able to insert one finger between the collar strap and your dog's skin;
  - e. Wash the dog's neck area and the correction poles as often as needed to keep the area and poles clean.If signs of skin irritation are noticed, immediately discontinue use and apply antibiotic ointment to help and sooth the area.

# Information for Terms of Use & Limitation of Liability

## 1. Terms of Use

This product is offered to you conditioned upon your acceptance without modification of the terms, conditions, notices contained herein. Usage of this product implies acceptance of all such terms, conditions, and notices.



## 2. Proper Use

This product is designed for use with dogs where training is desired. The specific temperament of your dog may not work with this product. We recommend that you not use this product if your dog is less than 8 pounds or if your dog is aggressive. If you are unsure whether this is appropriate for your dog, please consult your veterinarian, certified trainer or contact our customer support.

## 3. No Unlawful or Prohibited Use

This product is designed for use with dogs only. This dog training device is not intended to harm, injure, or provoke. Using this product in a way that is not intended could result in violation of Federal, State or local laws.

## 4. Limitation of Liability

In no event shall Aetertek be liable for any direct, indirect, punitive, incidental, special or consequential damages, or any damages whatsoever arising out of or connected with the use or misuse of this product. Buyer assumes all risks and liability from the use of this product.

**5. As agreed by related parts, the seller is responsible for after-sale service, and Aetertek company only provide technical support. So if you have any problems related to quality warranty, please contact the seller.**

## 6. Modification of Terms and Conditions

Aetertek reserves the right to change the terms, conditions, and notices under which this product is offered.

# Warranty Card

Thank you for purchasing our dog trainer, one of the best training systems available for training your dog. Aetertek warrant the product to be free from defects in material and workmanship, arising under normal use for a period of half a year from the date of original purchase when brand new. Misuse, loss or improper handling is not covered. Aetertek will not pay for transport/insurance costs incurred in returning the product to our authorized Reseller, such as loss of time, inconvenience, loss of use of your product, loss of your product and any incidental or consequential damages. To be entitled for 1 year international limited warranty of our dog trainer, please fill in the warranty card and keep it safe together with your proof of purchase. Failure to provide documentation will void warranty. This warranty extends only to original purchaser and is non-transferable.

## Statements for Warranty:

1: Please fill in the following form carefully. Information and signature of authorized distributor/reseller you purchased from are also required.

For Aetertek to Fill in:	
Series No:	
Authorized distributor/reseller's signature:	
For original purchaser to Fill in:	
Name:	Date purchased:
Address:	Tel No:
Authorized distributor/reseller you purchased from:	
Item No:	
Model NO.(e.g. AT-216C)	

2. If defected machine have been proven out of warranty for following reasons, we will charge maintenance/repair fee:

A: Warranty time expires.

B: Damages caused by injudicious operation or some irresistible external forces (such as : flood, fires, earthquakes, lighting, typhoon, etc.).

C: Damages caused by not abiding the clauses for operation, maintenance or storing the product in the user's manual.

D: Repaired, re-assembled, or changed components or circuits by user.

E: Opened the collar receiver or torn up the series number sticker or altered the warranty card's clauses by user

F: Other misuse or improper handling.

To help us solve the problems, please tick the relevant box/boxes:

NO	Descriptions of Defects	Please Tick
1	Appearance damage, need to replace shell or other components	<input type="checkbox"/> Yes
2	Receiver cannot be turned on	<input type="checkbox"/> Yes
3	LED light does not turn on	<input type="checkbox"/> Yes
4	Shock correction is not working properly, intensity level is not strong enough	<input type="checkbox"/> Yes
5	Vibration correction is not working properly, intensity level is not strong enough	<input type="checkbox"/> Yes
6	Beep correction is not working properly, intensity level is not strong enough	<input type="checkbox"/> Yes
7	LCD display cannot be turned on, back light cannot be turned on	<input type="checkbox"/> Yes
8	Buttons on transmitter do not work properly	<input type="checkbox"/> Yes
9	Collar cannot be charged properly	<input type="checkbox"/> Yes
10	Receiver cannot communicate with transmitter, transmitter does not send out signal	<input type="checkbox"/> Yes

**If not listed above, please state here:**

**As agreed by related parts, the seller is responsible for after-sale service, and Aetertek company only provide technical support.**

**So if you have any problems related to quality warranty, please contact the seller.**

**We reserve the rights to alter or cancel the warranty program at any time without prior notice.**